

**SURFACE MOUNT POWER
INDUCTOR SERIES LPPI3015**

FEATURES

- Low profile
- High reliability and efficiency
- RoHS compliant plus Lead & Halogen free
- Magnetically shielded

ELECTRICAL SPECIFICATIONS

- Inductance range 1.0uH to 47.0uH
- Test frequency 100KHz with test level 1 V
- Test equipment Quadtech 1910 L analyzer
- Rated current range 0.30 to 2.00 Amps
- Tolerance ± 20% (M) & ± 30% (Y)
- Rated current Refer to notes below

PHYSICAL SPECIFICATIONS

- Operating temp. -40°C to +125°C
- Core Ferrite core
- Terminal construction Ag/Ni/Sn plating
- Packaging T & R 2000 pieces per reel
- Tape & reel spec. Tape 8 mm embossed carrier
- Reel 178 mm reel

SPECIFICATIONS

Part Number	L (μH)	Tol % ±	DCR ±20% (mΩ)	Rated Current (A)	
				I _{rms} ⁽¹⁾	I _{sat} ⁽²⁾
LPPI3015-1R0Y	1.0	30	30.0	2.00	2.00
LPPI3015-1R5Y	1.5	30	40.0	1.80	1.80
LPPI3015-2R2M	2.2	20	60.0	1.50	1.50
LPPI3015-3R3M	3.3	20	80.0	1.20	1.20
LPPI3015-4R7M	4.7	20	120.0	1.00	1.00
LPPI3015-6R8M	6.8	20	160.0	0.90	0.90
LPPI3015-100M	10.0	20	220.0	0.70	0.65
LPPI3015-150M	15.0	20	320.0	0.60	0.55
LPPI3015-220M	22.0	20	460.0	0.50	0.45
LPPI3015-330M	33.0	20	800.0	0.40	0.35
LPPI3015-470M	47.0	20	1200.0	0.35	0.30

DIMENSIONS IN MILLIMETERS

- Length A 3.0 ± 0.2
- Width B 3.0 ± 0.2
- Height C 1.5 max.
- Terminal width D 1.0 ref.
- Terminal pitch E 1.0 ref.

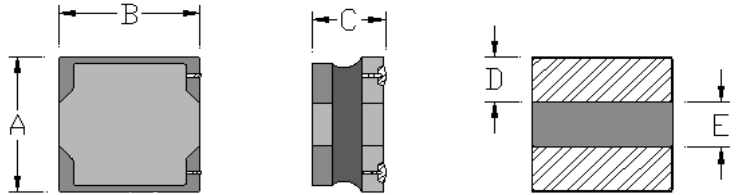

RECOMMENDED PC BOARD PATTERN

- L = 3.2 mm ref.
- G = 1.0 mm ref.
- H = 3.2 mm ref.

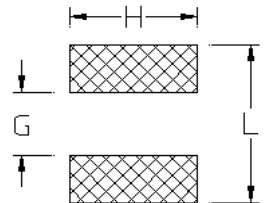

Notes:

- (1) Based on coil temperature rise ΔT approximately 40°C
- (2) L drops 30% from OCL typical

All test data based on 25°C ambient
 Part temperature (ambient + temperature rise) must not exceed 125°C under worst case operating conditions.
 Circuit design, components, PCB trace size, airflow and other cooling provisions all effect the part temperature.